

## A. 400V TRANSFORMER UNIT

The 400V transformer 'micron' adhesive melter is designed to be connected to a three phases power supply of 400V without neutral wire so it is specially prepared for this type of connection.

Thus, standard 'micron' adhesive melters are not allowed to be connected to this power supply and 400V transformer units are not allowed to be connected to a standard power supply.

**Warning:** Be sure your connection is well done before switch on the system. Otherwise it can result in damage to equipment or in serious personal injury.



### SAFETY

Before installing or operating the unit read carefully the information contained in '1. Safety' section.

### INTENDED USE

Both devices, transformer base and 400V adhesive melter, cannot be used separately because they are designed to operate together connected to a power supply of 3~ 400V 50Hz + PE.

These units are foreseen to be used under the conditions described in '2. Introduction' section.

### LIMITED USE

Likewise, the 'micron' series hot-melt melters/applicators must not be used, under any circumstances, for the purpose for which they are not designed. See '2. Introduction' section.

### TRANSFORMER BASE OPERATION

Transformer base unit has two main functions:

1. Acts as power supply input connection with the necessary electric protections.
2. Transforms power supply voltage to working voltage for hoses and guns heating (400V => 230V).

400V three phases power supply is distributed inside the unit as follows:

- one phase supplies directly power for tank and manifold resistors (400V).
- second phase supplies, by means a single phase 400/230V 1.5kVA transformer, the power control of 1, 3 and 5 channels (230V).
- third phase supplies, by means another single phase 400/230V 1.5kVA transformer, the power control of 2, 4 and 6 channels (230V).



Thus, hose-gun channels are limited up to 1500VA maximum power for 1, 3 and 5 channels and 1500VA maximum power for 2, 4 and 6 channels, with a maximum power of 1200VA for each individual channel.

## INSTALLATION

The transformer base unit is delivered from the factory assembled and wired to the melter unit. You have only to place all together on the base plate and make the power supply connection to the transformer base.

### Free space

The only dimension it is modified regarding the standard units is height. The following table shows the transformer base dimensions for each model.

MODEL	LENGTH	WIDTH	HEIGHT
micron 5	574 mm	324 mm	146 mm
micron 10	659 mm	324 mm	146 mm
micron 20	659 mm	366 mm	146 mm

### Electric power supply

400V 'micron' series with transformer are supplied to be connected to a electric power supply of 3~ 400V 50Hz + PE. Before connecting, make sure that the voltage that is being connected to the melter/applicator is the correct one appearing on the equipment's characteristics plate.

Connect the machine and check if it is well grounded.

Follow the steps described below:

1. Remove the cover where electrical cable gland Pg 13 is placed.
2. Thread the three phases power cord ( $\varnothing 6-12$  mm) through the electrical cable gland Pg 13 and fasten it to the inside anchor, making sure that the ground wire is well connected too.
3. Fix the cover again and press the electrical cable gland to fasten the cord. Switch on the transformer base.
4. Follow the instructions described in '4. Melter operation' section.



## CHARACTERISTICS

### MICRON 5

### MICRON 10

### MICRON 20

Power supply voltage	3 ~ 400V 50Hz + PE	3 ~ 400V 50Hz + PE	3 ~ 400V 50Hz + PE
Output power	2 x 230V 1,5 kVA	2 x 230V 1,5 kVA	2 x 230V 1,5 kVA
Dimensions with unit	587 x 341 x 627 mm	671 x 341 x 627 mm	671 x 382 x 670 mm
Weight	51,2 kg (empty)	60,2 kg (empty)	75,4 kg (empty)
Compatibility	With all 'T' version micron melters (micronX/X-1X0XT)	With all 'T' version micron melters (micronX/X-1X0XT)	With all 'T' version micron melters (micronX/X-1X0XT)

SPARE PARTS

N°	Ref.	Description
1	115000890	Transformer base 400/230V micron 5
1	115000900	Transformer base 400/230V micron 10
1	115000910	Transformer base 400/230V micron 20
1.1	150022130	Transformer 400/230V 1,5 KVA
1.2	150028170	Circuit breaker 3- pole 25A
1.3	10030007	Current connection strip
1.4	150022170	Switching contactor 4- pole 9A 400V
1.5	10140040	Cable gland PG-13
1.6	150114470	400V two contacts switch
	150115350	Micron tank 5 400V
	150115360	Complete tank assembly micron 5 400V
	150115370	Micron tank 10 400V
	150115380	Complete tank assembly micron 10 400V
	150115390	Micron tank 20 400V
	150115400	Complete tank assembly micron 20 400V
	150115410	Manifold heating element 300W 9.46 (3/8") X 177 400V

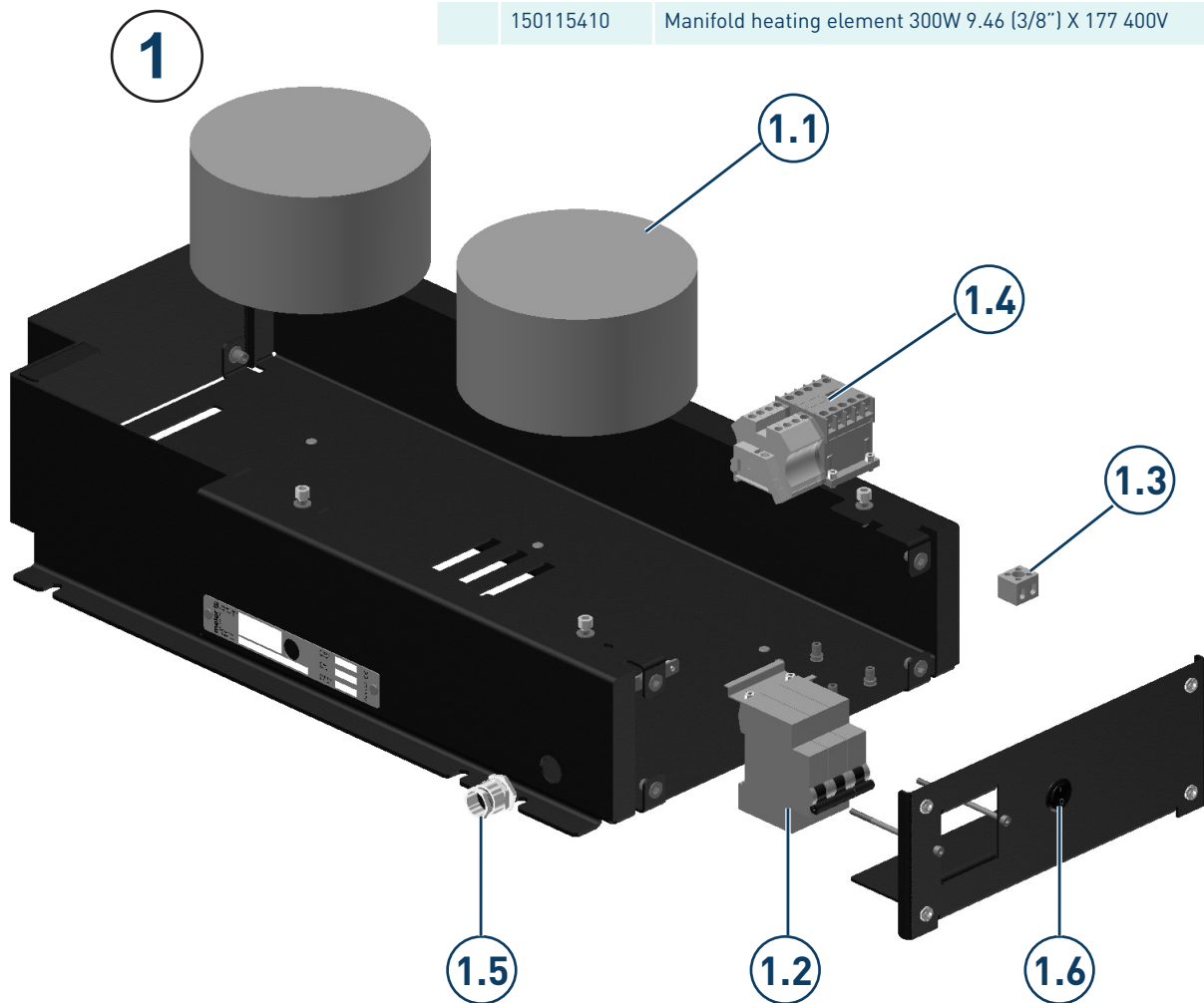



This page is intentionally left blank.